

Uniclass	L384/L385	
CI/SIB	(32.54)	X
December 2003		

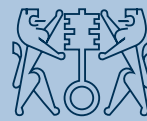

KARA®
HUFCOR
 Operable Partitions



**Hufcor Series 5000 Operable Walls
 Sales Specification**



KABA®
HUFCOR

Operable Partitions

Hufcor Series 5000 Operable Walls

High quality, high versatility at an affordable price

The design of the 5000 Series is specifically tailored to meet the requirement for low cost operable walls without sacrificing performance and choice. The system has an excellent feature list which brings significant benefits in use:

A strong lightweight aluminium frame surrounds and protects the perimeter of each panel.

The standard panel is only 85mm thick which means less storage space is required.

A 100mm thickness "trimless" version is available to achieve a plain wall appearance.

Vertical interlocking stiles and horizontal top and bottom seals help to achieve effective acoustic performance - up to 44dB.

Top hung panels are manufactured up to 5000mm high without the need for floor tracks or floor guides.

The well proven multi-directional track and carrier systems create easy movement through turns and crosses to remote storage.

The quick setting seal system creates fastest operable wall set up and storage.

For situations where it is impossible to employ top hung panels, a floor supported centre hung system is available with panels up to 4000mm high.



Access & Division of Space



Disabled Access Applications



Acoustic Applications



Environment Control Applications



Security Applications



Expert Guidance

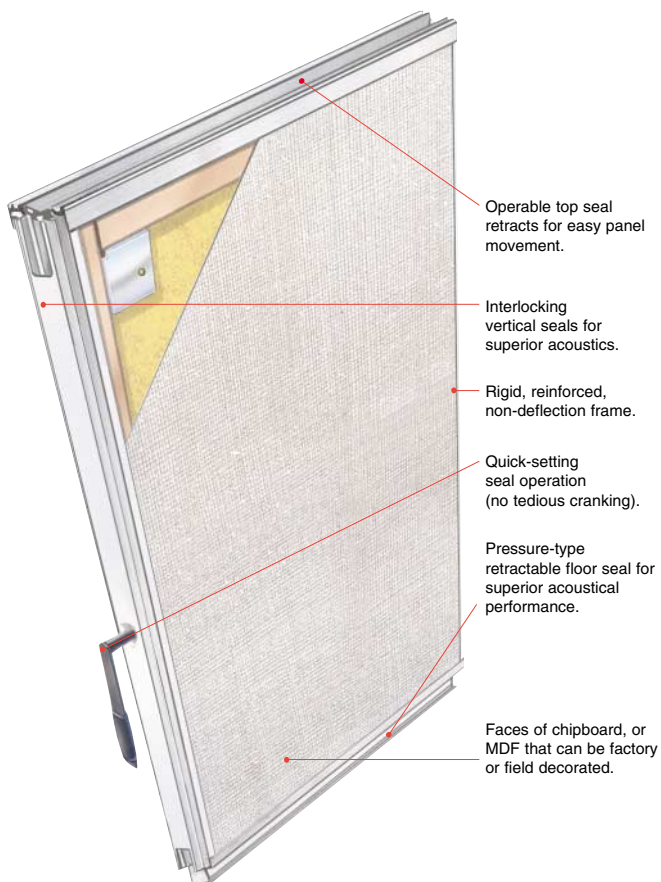

Operable top seal retracts for easy panel movement.

Interlocking vertical seals for superior acoustics.

Rigid, reinforced, non-deflection frame.

Quick-setting seal operation (no tedious cranking).

Pressure-type retractable floor seal for superior acoustical performance.

Faces of chipboard, or MDF that can be factory or field decorated.

MULTI-DIRECTIONAL PANELS The System for Remote Storage

Hufcor multi-directional partition systems give the most flexibility to your facility because each individual panel can easily turn corners and move to alternate locations or remote storage. Many different layouts can be created.

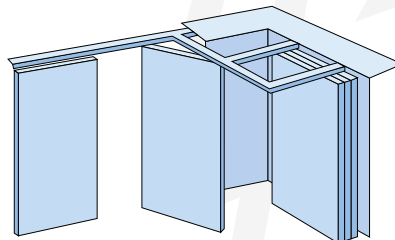

Individual panels, suspended by two dual horizontal wheel carriers, move through turns, crosses, and other intersections.

CENTRE-HUNG PAIRED PANELS The System for Fastest, Easiest Setup

When remote storage is not required, Hufcor centre-hung panels hinged in groups of two or three, are the ideal solution because they set up or stack more quickly than individual panels.

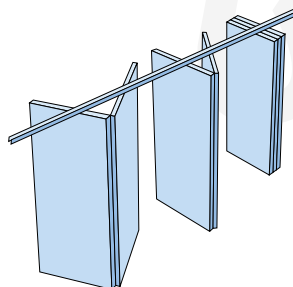

Paired panels can be moved quickly and quietly to either or both sides of the opening.

PANEL CONSTRUCTION

Panels are nominally 85 mm thick and usually of equal width up to 1220 mm wide, with silver anodised aluminium, which encases and protects the facing boards.

SEALS

Vertical sound seals are tongue and groove aluminium profile which incorporate double vinyl acoustical seals. Horizontal mechanical seals between the top of the panel and the top supporting track and the bottom of the panel and the floor are retractable to provide 25 mm nominal operating clearance. To accommodate greater floor variations and/or beam deflection a bottom seal with up to 50mm floor clearance can be provided. Top and bottom mechanical seals operate simultaneously with no more than a half turn of the removable handle. They provide a minimum of 13Kg and 18Kg force respectively when extended.

SUSPENSION SYSTEM

Suspension track is manufactured from silver anodised architectural grade aluminium alloy. The track incorporates steel pins for positive alignment of joints. Track intersections are constructed to enable smooth operation. For optimum sound control and good aesthetic appearance the track has integral support to allow the use of fascia boards or ceiling tiles. Carriers are manufactured with precision ground steel ball bearing wheels encased in moulded nylon tyres to protect the aluminium running track surface.

PARTITION SYSTEM

The lead panel has the option to close into an acoustical wall jamb or to use a vinyl bulb seal which does not require a wall jamb. The lever closure panel has an expandable jamb exerting a minimum of 110kg force to tighten the partition for optimum acoustics. For openings up to 3200mm, as an alternative to the lever closure panel, a full height end panel may be permanently hinged to a wall jamb and this may also be used to provide access between the divided areas.

FINISH OPTIONS

- | | | |
|----------------------------------|---|---|
| 1 Hufcor standard vinyls. | ✓ | ✗ |
| 2 Hufcor melamine or laminates. | ✓ | ✓ |
| 3 Wood veneers. | ✓ | ✓ |
| 4 Carpet. | ✓ | ✗ |
| 5 Plain MDF for site decoration. | ✓ | ✓ |
| 6 Free issue wall coverings. | ✓ | ✗ |

with trim

without trim

FIRE PERFORMANCE

Surface Spread of Flame

Hufcor Vinyls are flame resistant designated as 'Class 1' tested to BS476 part 7 1997.

Hufcor Wallcarpet offers 'Class 2' rating. 'Class 1' may be achieved by special treatment.

Class 0 Combustibility

Hufcor can achieve the requirements of 'Class 0' as defined in paragraph A12(b) of Approved Document B, "Fire Safety", to the Building Regulations, 1991. Veneers require an intumescent lacquer to achieve 'Class 0' rating.

ACOUSTICS

Series 5000 has been tested by a recognised independent acoustical laboratory according to both BS EN ISO 140-3 and ASTM E 90 standard for sound ratings.

WARRANTY

The partition system is covered by a two year warranty against material defects and workmanship.

ACCESSORIES

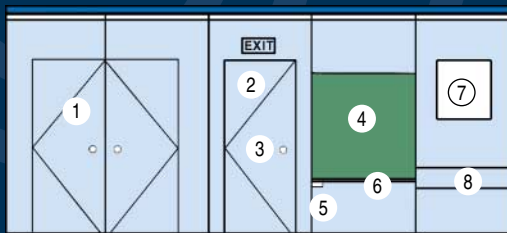

A variety of accessories and work surfaces is available to provide just the functionality you need.

- 1—Double Inset Pass Door
- 2—Single Inset Pass Door
- 3—Disabled Access Door Furniture
- 4—Work Surface: Pinboards, Dry Marker Board
- 5—Eraser Pocket
- 6—Recessed Chalk/Marker Pen Rail
- 7—Vision Panel
- 8—Inset Chair Rail

Typical panel joint



Multi-directional track system



Centre hung paired panel track system

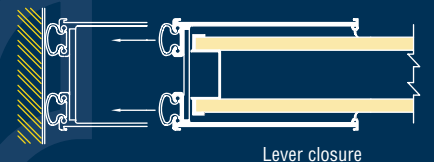

Lever closure

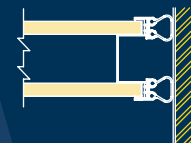

Bulb seal

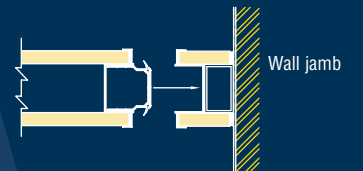

Wall jamb



KABA®

HUFCOR

Operable Partitions

HUFCOR SERIES 5000 OPERABLE WALLS

Multi-Directional Models	Centre Hung Paired Panel Models	Acoustic Rating dB	Approx. Weight Kg/m ²
5635	5535	35	25
5641	5541	41	28
5644	5544	44	34

Tested in accordance with BS EN ISO 140-3:1995
Rated in accordance with BS EN ISO 717/1:1997



Kaba Hufcor Operable Partitions

Trent Lane, Castle Donington,
Derby DE74 2NP

Tel: +44 (0) 870 000 5250

Fax: +44 (0) 870 000 5251

Email: hufcor@kdt.kaba.com

web: www.kaba.co.uk

www.hufcor.com

As ours is a policy of progressive design, we reserve the right to amend and alter specifications without prior notice.

Your local Hufcor Distributor:

mk door systems
MOVEABLE PARTITION SPECIALISTS

M K Door Systems Ltd Unit 15 Whitwick Business Centre

Stenson Road Coalville Leicestershire LE67 4JP

Tel: 01530 276517 Fax: 01530 276518

E-mail: sales@mkdoorsystems.co.uk <http://www.mkdoorsystems.co.uk>